

45° Ell (S x S) Schedule 80 Harvel® PVC

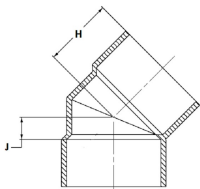
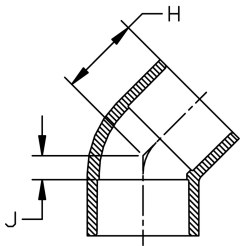
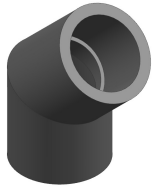

Image for 14"-24"
Fabricated

Size (inch)	P/L	Part No.	Pack Qty	H (inch)	J (inch)	Design
¼	608	817-002	50	0.81	0.18	HS
⅜	608	817-003	50	0.94	0.19	HS
½	608	817-005	25	1.22	0.30	SL
¾	608	817-007	20	1.29	0.28	SL
1	608	817-010	25	1.48	0.32	SL
1 ¼	608	817-012	15	1.78	0.47	SL
1 ½	608	817-015	10	1.88	0.45	SL
2	608	817-020	5	2.16	0.60	SL
2 ½	608	817-025	5	2.56	0.79	SL
3	608	817-030	5	2.67	0.77	SL
4	608	817-040	5	3.31	1.04	SL
6	608	817-060	2	4.86	1.77	SL
8	608	817-080	2	6.15	2.07	SL
10	602	817-100	1	7.51	2.46	SL
12	602	817-120	1	9.00	2.96	SL
14	A33	817-140N	1	10.25	3.50	FAB
16	A33	817-160N	1	11.75	3.75	FAB
18	A33	817-180N	1	13.25	4.25	FAB
20	A33	817-200N	1	14.75	4.75	FAB
24	A33	817-240N	1	17.75	5.75	FAB

The technical data are not binding. They neither constitute expressly warranted characteristics nor guaranteed properties nor a guaranteed durability. They are subject to modification. Our General Terms of Sale apply.

Georg Fischer Piping Systems Ltd, Postfach, CH-8201 Schaffhausen/Switzerland

Phone +41 -(0)52-631 1111

e-mail: info.ps@georgfischer.com

Internet: <http://www.gfps.com>